

CURVE	DELTA	RADIUS	LENGTH
C79	29°49'32"	98.00'	51.01'
C80	27°51'53"	30.00'	14.59'
C81	0°51'00"	80.00'	1.19'

EAST CLIFF DRIVE PARKWAY PLAN STA 34+00 - 37+00
SCALE: 1" = 10'

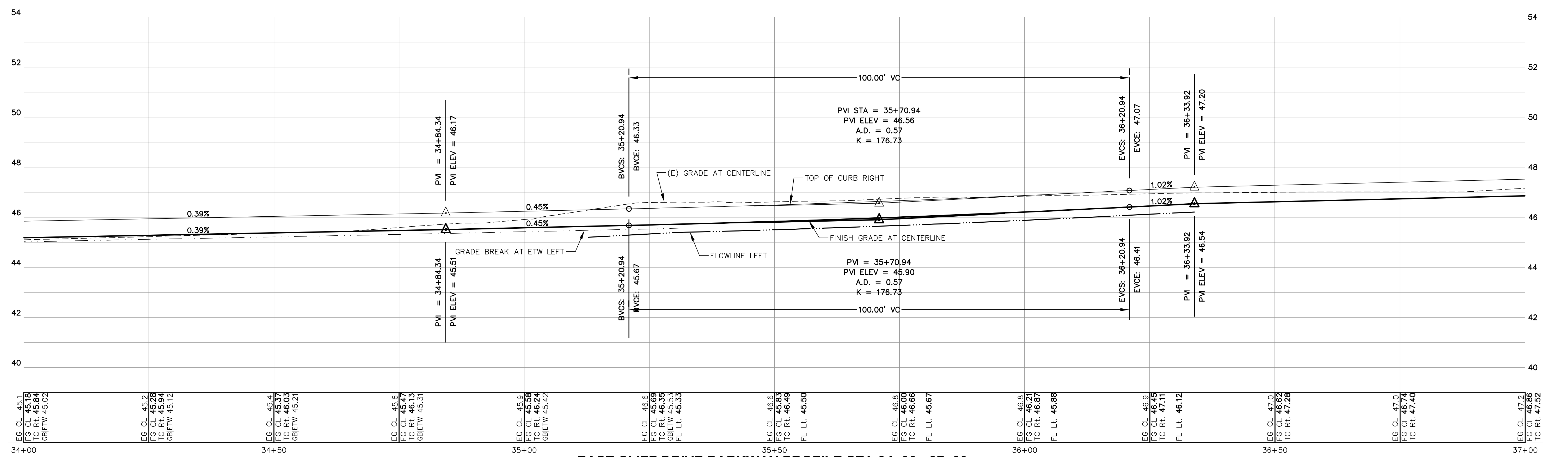

EAST CLIFF DRIVE PARKWAY PROFILE STA 34+00 - 37+00
SCALE: 1" = 10' HORIZONTAL, 1" = 2' VERTICAL

WHITSON ENGINEERS
2425 Porter Street - Suite 2 - Soquel, CA 95073
831 464-9363 • Fax 831 464-2316

CIVIL ENGINEERING • LAND SURVEYING • PROJECT MANAGEMENT

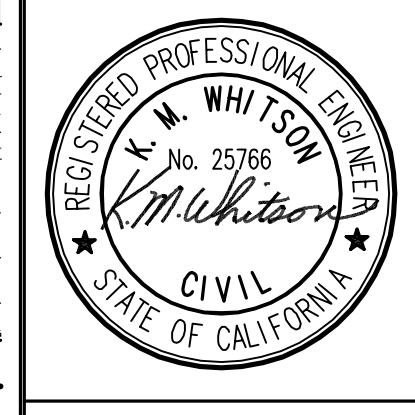

County of Santa Cruz
Department of Public Works
701 Ocean St., Rm. 410
Santa Cruz, CA 95060-4000
Phone: (831) 452-2180
Fax: (831) 454-2265

GRADING AND DRAINAGE
PLAN AND PROFILE
STA 34+00 - STA 37+00
EAST CLIFF DRIVE PARKWAY PROJECT
32nd AVENUE TO 41st AVENUE

County of Santa Cruz

REV	DATE	DESCRIPTION
1	03/22/10	75% SUBMITTAL
2	10/08/10	95% SUBMITTAL
3	07/12/11	BID SET

DATE: SEPTEMBER 2010
SCALE: AS NOTED
DESIGNED BY: MS/RT
DRAFTED BY: RT/SG
CHECKED BY: KW
JOB NO.: 2280.01
FILE: Civil Plan.dwg